

Product formal size

Custom adjust is accepted

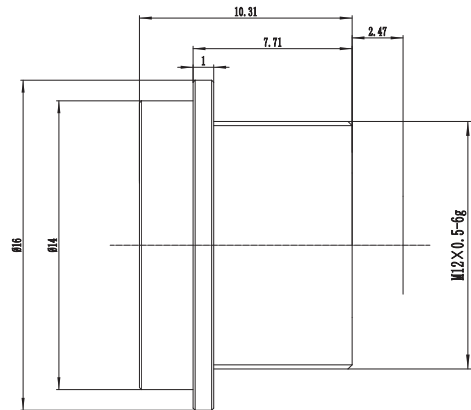

Characteristic

- ⇒ Big field angle with low distortion, fit 360° Surround View System well.
- ⇒ Suit for 1/3", 1/3.7", 1/4" sensors.
- ⇒ All glass lenses, operating temperature from -40°C to 105°C, suit for automotive cars.
- ⇒ Wear-resistan&Waterproof&Multi-layer coating, provide great protection and transmittance.
- ⇒ Very short total length, suit for compact assembly space.

ACL-M12-3.2(MP)				
Image Circle		Φ4.8mm		
Focal Length		3.2mm		
Relative Aperture		F 2.5		
Mount		M12×0.5		
FOV	Sensor	1/3"	1/3.7"	1/4"
	D	100°	100°	90°
	H	99°	78°	68°
	V	68°	55°	50°
Optical Resolution Minimum		On-axis : 63.0%@84lp/mm		
		1.9mm image circle:T≈72.8%; S≈70.2%@84lp/mm		
		4.0mm image circle:T≈53.8%; S≈64.5%@84lp/mm		
Optical Distortion		-36%		
IR Cut-off		650nm±20nm at 50% normalized transmittance		
AR Coating		Multi-layer BBAR coating (typical reflectivity<1% on front surface, <0.5% on others)		
M. O. D.		0.3m		
Dimension		Φ16×10.3mm		
Total Track Length		12.4mm		
BFL		3.1mm		
MBF		2.5mm		
Operation	Iris	Fix		
	Focus	Manual		
Ingress Protection		IP 68		
Operating Temperature		-40°C ~+105°C		